



Beltone TRUE

Instructions for use
Digital Receiver In-the-Ear (RIE)
hearing instrument



FCC ID: X26SY312

Statement:

This device complies with Part 15 of the FCC Rules.

Operation is subject to the following two conditions: (1) this device may not cause harmful interference, and (2) this device must accept any interference received, including interference that may cause undesired operation.

Note: This equipment has been tested and found to comply with the limits for a Class B digital device, pursuant to part 15 of the FCC Rules. These limits are designed to provide reasonable protection against harmful interference in a residential installation. This equipment generates, uses and can radiate radio frequency energy and, if not installed and used in accordance with the instructions, may cause harmful interference to radio communications. However, there is no guarantee that interference will not occur in a particular installation. If this equipment does cause harmful interference to radio or television reception, which can be determined by turning the equipment off and on, the user is encouraged to try to correct the interference by one or more of the following measures:

- Reorient or relocate the receiving antenna.
- Increase the separation between the equipment and receiver.
- Connect the equipment into an outlet on a circuit different from the one in which the receiver is connected.
- Consult the dealer or an experienced radio/TV technician for help.

Changes or modifications can void the user's authority to operate the equipment

Intended use:

Hearing Instruments are intended for hearing impaired people to improve their hearing. The essential performance of Hearing Instruments is to receive, amplify and transfer sound to the ear drum of a hearing impaired person.

List of countries:

Products without wireless functionality are intended for worldwide sales.

Products with wireless functionality are intended for sale in countries within European Economic Area as well as Switzerland.

Specification of restrictions:

You are not allowed to operate the equipment within 20 km of the centre of Ny Ålesund, Norway.

The products are in compliance with the following regulatory requirements:

- In EU: the device conforms to the Essential Requirements according to Annex I of Council Directive 93/42/EEC for medical devices (MDD) and essential requirements and other relevant provisions of Directive 1999/5/EC (R&TTE). The declaration of conformity may be consulted at www.beltone-hearing.com
- In US: FCC CFR 47 Part 15, subpart C, section 15.249
- Other identified applicable international regulatory requirements in countries outside EU and US. Please refer to local country requirements for these areas.
- Products are categorized as class 2 receiver according to EN 300 440

A new Beltone hearing instrument

Congratulations on your choice of a Beltone hearing instrument!

This is an important step towards clearer hearing and better understanding. We have used all our experience with hearing instruments to help you communicate, lead an enjoyable social life and listen to the world around you.

Your hearing instrument is a very advanced device. Your hearing care practitioner has tuned it to your individual needs. With a little devotion and patience you will become familiar with it.

This booklet is a short guide to assist you in getting acquainted with your hearing instrument. Read it carefully and use it as a guideline.

We wish you happiness and pleasant listening with your new instrument.

Beltone

This booklet & your instrument

In this booklet you will find instructions for inserting and controlling your new hearing instrument. You will find explanations on controlling your instrument, on daily handling and on its use. Furthermore, you can read what to do if things do not live up to your expectations. We will give a few practical steps towards better hearing.

Contents

Warning to hearing care professional	7
Your Hearing Instrument	8
On/Off function	10
Delayed Activation	10
Changing batteries	11
Inserting and removing the device	13
Program button	16
Telephone use	17
Auto-phone	17
Listen to radio or TV	19
Flight mode	19
Daily maintenance	20
The receiver tube	21
Cleaning the receiver tube and the receiver domes	21
Cleaning the RIE mold	22
How to mount receiver domes	23
Double wax guard filter	26
Changing wax guards	27
General precautions	29
General warnings	30
Eight steps towards better hearing	31
Troubleshooting guide	34
Technical specifications	36
International warranty, service and repairs	37
Your selected model	38

Warning to hearing care professional



A hearing care professional should advise a prospective user to consult promptly with a licensed physician (preferably an ear specialist) before setting the instrument if the hearing care professional determines through inquiry, actual observation, or review of any other available information concerning the prospective user that the prospective user has any of the following conditions:

- (i) visible congenital or traumatic deformity of the ear;
- (ii) history of active drainage from the ear within the previous 90 days;
- (iii) history of sudden or rapidly progressive hearing loss within the previous 90 days;
- (iv) acute or chronic dizziness;
- (v) unilateral hearing loss of sudden or recent onset within the previous 90 days;
- (vi) audiometric air-bone gap equal to or greater than 15dB at 500 Hz (hertz), 1000 Hz, and 2000 Hz;
- (vii) visible evidence of significant cerumen accumulation or a foreign body in the ear canal;
- (viii) pain or discomfort in the ear.

Your Hearing Instrument

(Please see page 38 for your selected model)

1. Receiver tube
- 2a. Receiver Mini Dome
- 2b. Receiver Standard Dome
- 2c. Receiver Power Dome
- 2d. RIE mold
3. Sports lock
4. Battery compartment
5. Receiver
6. Push button

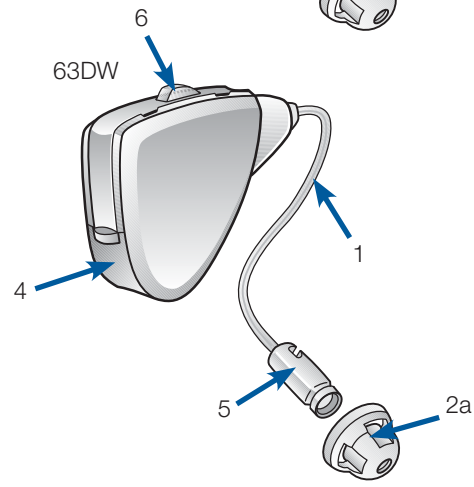
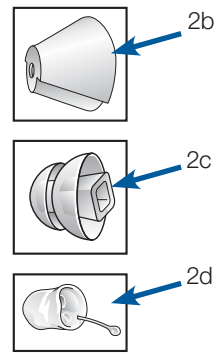
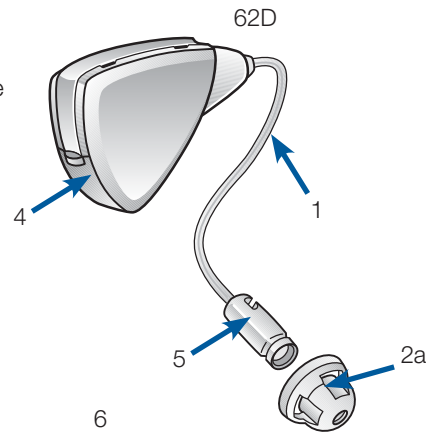

- 6. Model, and serial number
- 7. Left/right indicator
- 8. MPG receiver tube
- 9. HPG receiver tube

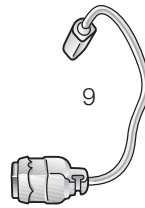
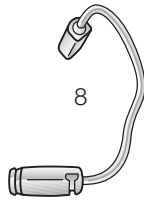
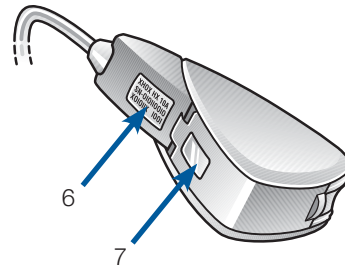
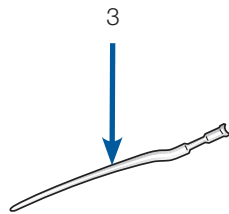

On/Off function

Your hearing aid is equipped with an on/off switch integrated into the battery compartment.

When the battery compartment is fully closed, the instrument is turned on. To turn the instrument off, grasp the battery compartment door with your fingernail and gently pull downwards. The power will switch off at the point where you can feel a small click. Whenever you are not wearing the instrument, remember to turn it off to reduce battery consumption.

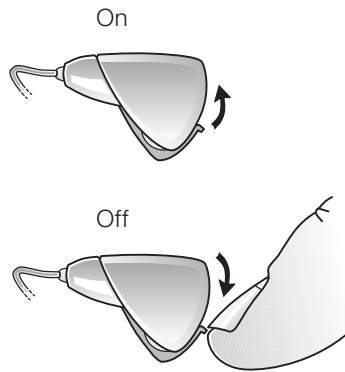

Delayed Activation

Your hearing care professional may have activated the Delayed Activation function in your hearing instrument. The Delayed Activation delays the switch-on time 10 seconds after closing the battery compartment. This is indicated by beeps at one second intervals after closing the battery compartment, which means that you could hear 10 beeps before the hearing aid is activated.

If you wish, it can be inactivated by your hearing care professional.

Changing batteries

(Please see “Your selected model” for the battery size of your hearing instrument)

Low battery indication

When the battery voltage/power decreases to a certain level, the instrument will stop amplifying and emit a soft beeping signal. This signal will continue for about one minute and sequence will continue every five minutes until the instrument will be automatically switched off. It is recommended that you keep a spare set of batteries on hand.

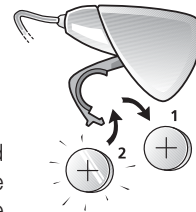

Low battery indicator (when paired with Direct Line accessories)

Active usage of Beltone Direct Line accessories (for example: Remote Control, TV Link, and Phone Link) requires more battery power from the hearing instrument than when these are working on their own. When the battery in the hearing instrument has depleted to a level at which use of the Beltone TV Link and Phone Link cannot be supported, the hearing instrument will play two sets of descending tones. At some point the battery level will not support the remote control either and you will once again hear the descending tones. The hearing instrument will continue to work as usual. Once a new battery is inserted, full operation of the accessories will resume.

Replacing the battery

Open the battery compartment completely by using your fingernail. After removing the old battery (if present), insert the new one with the positive (+) side in the correct position. Please make sure that you have the correct size battery to your hearing instrument. Gently close the battery door. Do not force it closed. If door does not close easily, remove battery and try again.

For best performance, always use new Zinc-Air batteries that have a minimum remaining shelf life of 1 year.

Battery warning information



Batteries contain dangerous substances and should be disposed of carefully in the interest of your safety and for the environment.

- Keep batteries away from pets, children and mentally challenged persons.
- Batteries can be harmful if swallowed. If you do, seek medical attention immediately.
- DO NOT burn the batteries, as they could explode.
- DO NOT attempt to recharge batteries (Zinc Air) which are not specifically designated rechargeable as they may leak or explode.
- Replace spent batteries and do not leave them in the instrument for a prolonged period to prevent leakage.
- Used batteries are harmful to the environment. Please dispose of them according to local regulations or return them to your hearing care practitioner.

Inserting and removing the device

Inserting custom RIE molds:

1. Hold the RIE mold between your thumb and index finger and position its sound outlet in your ear canal.
2. Slide the RIE mold all the way into your ear with a gentle, twisting movement.
3. Move the RIE mold up and down and gently press to ensure it is positioned correctly in the ear. Opening and closing your mouth can ease insertion.
4. Make sure the hearing instrument is seated behind the ear.

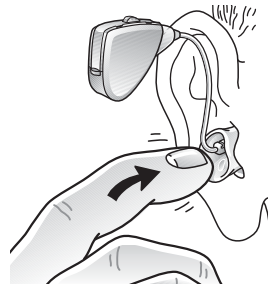
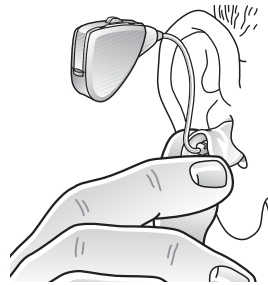

Inserting receiver domes:

1. Hang the instrument over the top of the ear.
2. Grasp the receiver tube where it bends and push the receiver dome into your ear canal. The receiver dome should be placed far enough into the ear so that the receiver tube lies flush with your head.
3. If the hearing care professional has provided you with a sport lock on the receiver tube, make sure to position it into the indentation above the earlobe.
4. When the receiver dome is placed appropriately, you should not see the receiver tube sticking out when you look directly into a mirror.

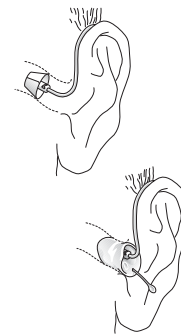
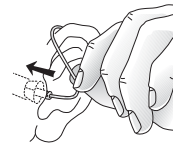
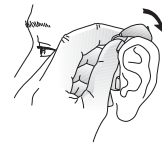

If the device whistles, the most likely reason is that the receiver dome is not placed correctly in the ear canal. Other reasons can be build-up of earwax in the ear canal. It is also possible that the instrument settings are not optimal. To help you solve these issues it is recommended to contact your hearing care professional.

Removing:

1. Grasp the receiver tube where it bends, or pull-out cord when using an RIE mold, and pull the receiver dome out of your ear canal.

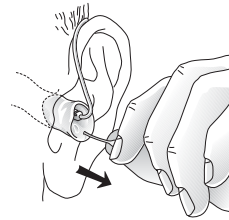
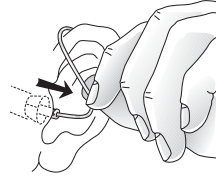

2. Lift the hearing instrument of your ear.

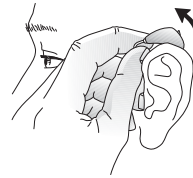

Note: You should never attempt to bend or modify the shape of the hearing instrument, RIE molds, or receiver tubing yourself.

Program button

If you have a hearing aid with a program button this will allow you to use up to four different listening programs, each of them suitable for certain situations.

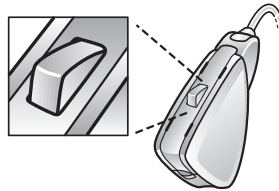

After pressing the program button, the instrument will switch program. If it was in program 1 it will switch to program 2, if it was in program 2 it will switch to program 3 etc. If program 2, 3 or 4 are not activated, nothing will happen. Your instrument will give an audible signal after pressing the program button.

A little later, the instrument will give:

- one single beep if set in program 1
- two beeps if set in program 2
- three beeps if set in program 3
- four beeps if set in program 4

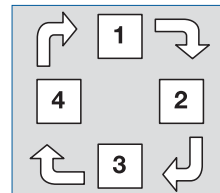

When you close the battery door and switch the instrument on it will start in program 1, confirmed by one single beep. Press the program button if you want to move to a different listening program.

Let your hearing care practitioner fill out the following table:

Program number	Type of program	Intended for
1		
2		
3		
4		

Telephone use

Your hearing instrument allows you to use the telephone as you ordinarily do. Hold the phone up to your ear as you normally would. It is possible you will hear clearer if you hold the phone towards the top of your ear (closer to where the microphones are located).

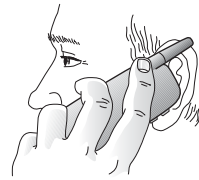

If you experience discomfort from the dome pressing in your ear canal, you may need a different size sound tube. In this case contact your hearing care professional.

Your hearing care professional can design a telephone program that you can switch to when using the phone. This program is designed to ease listening on a phone. If you have a hearing instrument with a program button, you can switch to this program manually. Your hearing care professional can also enable the Auto-phone function to switch to the telephone program automatically.

Auto-Phone

The Auto-Phone function, allows your hearing instrument to automatically switch to your telephone program when a telephone receiver is raised to the ear. When the telephone receiver is removed from the ear, the hearing instrument automatically returns to the previous listening program.

Placement of Auto-Phone magnets

In order to place magnets properly:

1. Clean the telephone receiver thoroughly.
2. Hold the telephone vertically, in a position similar to when making a telephone call.



3. Place the magnets just below the telephone receiver. If necessary, move the magnet to another position to improve ease of use and comfort while speaking.
4. Use only recommended cleaning agent to clean the telephone prior to placing the magnet on the phone.

Auto-Phone usage

Telephones can be used in a normal manner. A short melody will indicate that the Auto-Phone feature has automatically switched to the program designed specifically for listening on the phone. Initially, you may need to move the telephone receiver slightly to find the best position for reliable Auto-Phone activation and good hearing on the telephone. If the switching mechanism is not reliable or consistent, additional magnets can be placed on the telephone.

Auto-Phone precautions



1. Keep magnets out of reach of pets, children and mentally challenged persons. If a magnet is swallowed, please seek advice from a medical practitioner.
2. The magnet used to strengthen the magnetic field of a telephone receiver may affect functionality of some medical devices or electronic systems. Always keep the magnet or a telephone equipped with the magnet at least 30 cm (12") away from pacemakers, credit cards and other magnetically sensitive devices.
3. High distortion during dialing or phoning may mean that the magnet is not in the optimal position relative to the telephone receiver. To avoid the issue, please move the magnet to another place on the telephone receiver.
4. Only use magnets supplied by Beltone

Listen to radio or tv

When listening to the TV or the radio, start out by listening to news commentators since they usually speak clearly, then try other programmes.

If you find it difficult to listen to TV or radio, your hearing care professional will be able to give you advice on available accessories to enhance your listening capabilities for TV and radio.

Cellular phones

Your hearing instrument is designed to comply with the most stringent Standards of International Electromagnetic Compatibility. However, not all cell phones are hearing instrument compatible. The varying degree of disturbance can be due to the nature of your particular cellular phone or of your wireless telephony service provider. If you find it difficult to obtain a good result while using your cellular phone, your hearing care professional will be able to give you advice on available accessories to enhance listening capabilities.

Flight mode*

When boarding a flight wireless functionality must be deactivated, as it is not allowed to radiate radio signals during flights. It is possible to disable wireless operation by opening and closing the battery compartment of the hearing instrument while at the same time pressing the program button.

When disabled manually, wireless operation may be re-enabled by opening and closing the battery compartment normally, (i.e. without at the same time pressing the program button) .

**instruments paired with wireless accessories only*

Daily maintenance

Keep your hearing instrument clean and dry. Wipe the case with a soft cloth or tissue after use to remove grease or moisture. You should avoid exposing your instrument directly to moisture such as rain or water from the shower. If your instrument does get wet or if it has been exposed to high humidity or perspiration, it should be left to dry out overnight with the battery out and the battery compartment open. It is also a good idea to put them in a sealed container together with a drying agent (dessorbent) overnight. Consult your hearing care professional as to which drying agent to use.

Your hearing instrument is protected by a protective, hydrophobic nanocoat material: HPF80 NanoBlock. It will improve the durability of your hearing instrument by repelling moisture and debris. However, to avoid the need for unwarranted repairs:

- Never immerse the instrument in water or other liquids since this may cause permanent damage to the circuitry.
- Protect your hearing instrument from rough handling, and avoid dropping it on hard surfaces or floors.
- Do not leave the instrument in or near direct heat or sunlight since excessive heat can damage the instrument or deform the casing or the receiver tube.

The receiver tube

The receiver tube comes in two different types; MPG (Medium Power Gain) and HPG (High Power Gain). Please see illustrations.

Depending on your hearing loss you have either been fitted with the MPG or the HPG receiver type. Please see page 38 to see your selected type. The receiver tube contains the wiring to the receiver which delivers the sound direct in the ear canal. It is important that the receiver tube and the receiver dome/RIE mold fit correctly into your ear. If the receiver tube or the receiver dome/RIE mold irritate your ear in any way and prevent you from wearing your hearing instrument, please contact your hearing care professional. You should never attempt to modify the shape of the receiver tube yourself. The receiver tube and the receiver dome/RIE mold should be cleaned regularly.

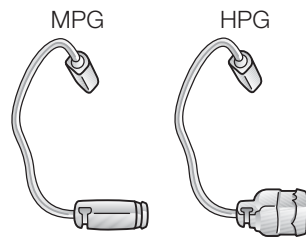

Cleaning the receiver tube and the receiver domes

The receiver tube and the receiver dome should be cleaned regularly. Use a damp cloth to clean the receiver tube and receiver dome on the outside. Do not use water when you are cleaning the receiver tubes or the receiver domes. Please see instruction on pages 27-28 for how to change the HF3 wax guard filter.

Cleaning the RIE mold

We recommend that you use a damp cloth to clean the RIE mold after every time you use it. It's important to keep it clean from wax so that you will not have wax or bacteria building up on the mold.

If you no longer can clean the RIE mold using a damp cloth we recommend you to contact your hearing care professional for them to clean it, using water and soap. If your hearing care professional has instructed you to clean it yourself this way, please follow the instructions below.

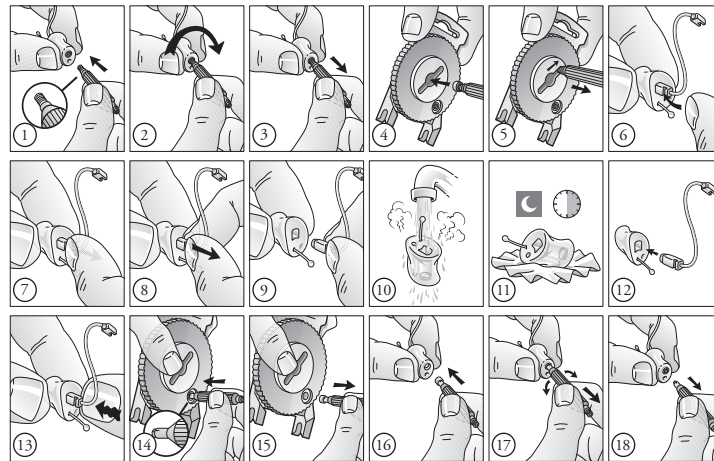

The receiver domes

The receiver Mini Dome / Standard Dome / Power Dome should be changed every third month or sooner if needed. We recommend that you have your hearing care professional change the receiver Mini Dome / Standard Dome / Power Dome for you. If your hearing care professional instructs you to change the receiver domes yourself, make sure that they are securely fastened to the receiver tube before inserting them in your ear. A failure to change the domes in accordance with the instructions could result in injury. If you have been fitted with a receiver Power Dome we strongly recommend that your hearing care professional change the dome since this needs to be done with a tool.

How to mount the receiver Mini Dome

The receiver Mini Dome is mounted by pushing it gently over the receiver at the end of the receiver tube.

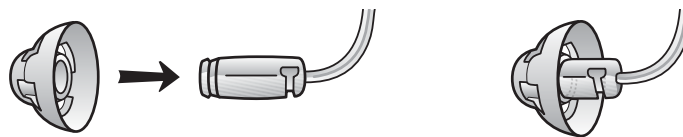

How to mount the receiver Standard Dome

The receiver Standard Dome is mounted by gently pushing it over the receiver at the end of the receiver tube (1) + (2).

The receiver Standard Dome should be directed with the sound outlet hole facing either down towards your shoulders or up towards your hair (3).

The sound outlet hole can turn both ways; the direction of the sound outlet hole affects the length of the sound tube according to the entrance of your ear canal.

Please ask your hearing care professional which way the sound outlet hole should turn in your ear.

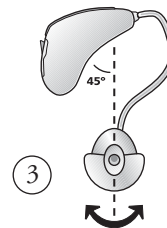
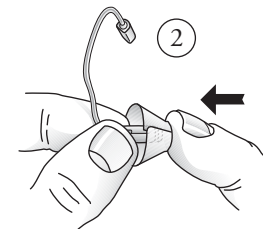
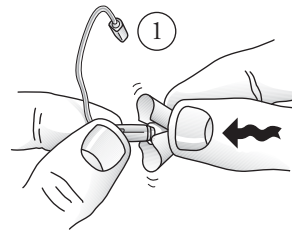

The receiver Standard Dome consists of two “leaves” and it is important that the largest “leaf” is the outermost “leaf” (4).

This can easily be done by pushing the “leaves” away from the receiver tube with your forefinger and middle finger (5). This will make the large “leaf” bend forward. Then you push it back and it will be placed on top of the smaller “leaf” (6). Now the receiver Standard Dome is ready for insertion (7).

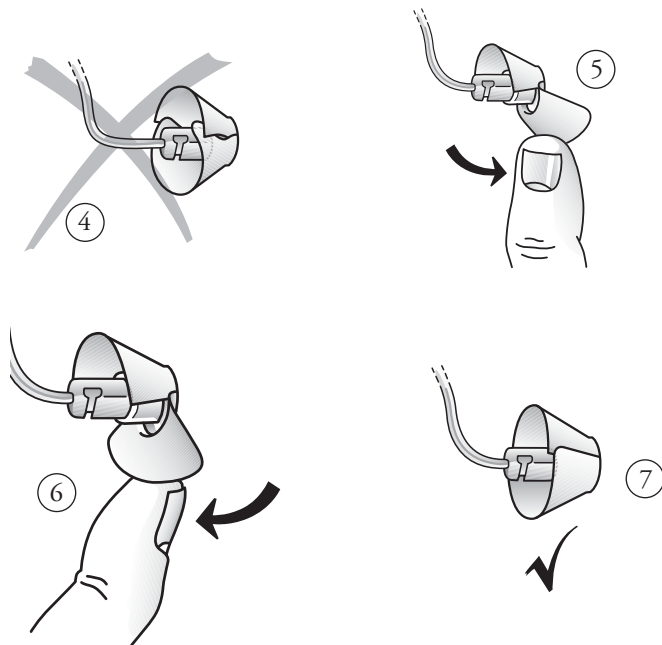

How to mount the receiver Power Dome

We strongly recommend that you always turn to your hearing care professional when the power domes need to be changed, since it can only be mounted the correct way with a tool. If mounted incorrectly there is a risk that the dome will come off and stay in your ear canal.

We advise you to have them changed when the domes are turning yellow in color, get's damaged or can no longer be cleaned with a damp cloth.

Double wax guard filter

Your hearing instrument has two types of wax guard filters to increase the protection against wax and moisture to damage the hearing instrument.

The first wax guard filter is molded into the Receiver domes. This will act as the front protection.

The second wax guard filter is placed at the front of the receiver or inside the dome if the hearing care professional has fitted you with a High Power Gain (HPG) receiver (please see illustration of the receiver type on page 9). The type is called HF3. They come in both red and blue. This will indicate on what ear the hearing instrument is sitting. Red for right and blue for left.

We recommend that your hearing care professional change them for you. If your hearing care professional has instructed you to change them yourself, please follow the instructions below.

Changing wax guard for MPG receiver tube

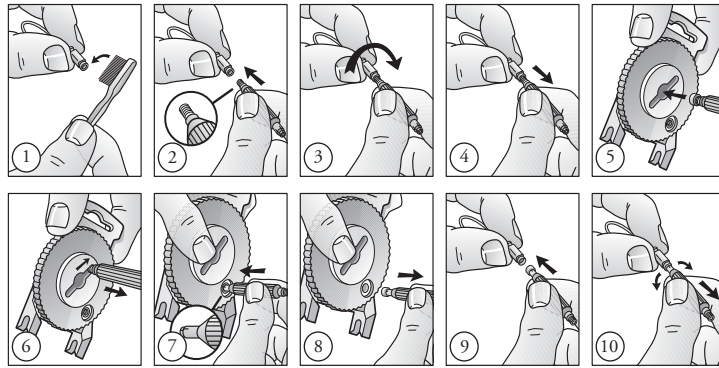

Changing wax guard for HPG receiver tube

Power Dome:

Please contact your hearing care professional for them to change the wax guard in the power dome for you.

Changing wax guard for HPG receiver tube

RIE mold:

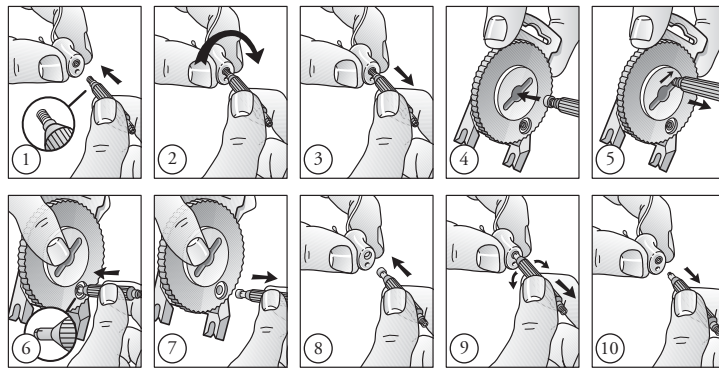

General precautions

- Do not leave your instrument in the sun, near an open fire or in a hot, parked car.
- Do not wear your instrument while showering, swimming, in heavy rain or in a moist atmosphere such as steam bath or sauna.
- Should your instrument become moist, put it in a dessicator. Your hearing care professional will be happy to counsel on this.
- Remove your instrument when applying cosmetics, e.g. perfume, aftershave, hair spray, suntan lotion.
- Wearing an instrument might cause an increased production of earwax. In rare cases, the anti-allergenic materials may cause skin irritation. If so, or if in doubt, consult your physician or ENT.
- Only connect and use Beltone Direct Line accessories. For further guidance, please refer to the relevant Beltone Direct Line user guide.
- Only connect Beltone hearing instruments to Beltone accessories intended and qualified to be used with Beltone hearing instruments.
- When wireless function is activated, the device uses low-powered digitally coded transmissions in order to communicate with other wireless devices. Although unlikely, nearby electronic devices may be affected. In that case, move the hearing instrument away from the affected electronic device.
- When using wireless functionality and the devices are affected by electromagnetic interference, move away from the source.

General warnings

Hearing instruments can be dangerous if improperly used.

- Consult a physician if you find a foreign object in your ear canal, if you experience skin irritation or if excessive ear wax accumulates with the use of the instrument.
- Different types of radiation, (e.g. from X-ray, MRI, NMR, CT scans), may damage the instrument. Therefore, do not wear the instrument during these or other corresponding scanning procedures. Other types of radiation (burglary alarms, room surveillance systems, radio equipment, mobile telephones, etc) will not damage the instrument. They could, however, momentarily affect the sound quality or create strange sounds from the instruments.
- Do not wear the instrument in mines or other explosive areas, unless those areas are certified for hearing instrument use.
- Do not allow others to use your hearing instrument. It may cause them permanent hearing damage.
- Instrument usage by children or mentally challenged persons should be supervised at any time.
- Instruments should be used only as prescribed by your hearing care professional. Incorrect use may result in sudden and permanent hearing loss.
- The instrument contains small parts which may present a choking hazard. Keep away from children under the age of 3.
- Turn off your wireless functionality by using flight mode in areas where radio frequency emissions are prohibited.
- Be careful when boarding flights to deactivate the wireless functionality

Eight steps towards better hearing

You need to get used to your new hearing instrument. Sounds seem new and different. That is because you grew accustomed to your diminished hearing. Therefore, familiar sounds seem strange or unnatural at first. Every first-time user of a hearing instrument responds differently to this. Some can wear the new instrument a whole day right from the start, while others find it hard to get used to.

After a while, you will notice you appreciate hearing with a hearing instrument and that you will find it quite normal. Below, eight steps are described that will guide you through the initial period. If you are not satisfied or keep experiencing problems, please consult your hearing care practitioner.

1. Get used to familiar sounds at home

Try to get used to the new sounds from a familiar environment. Listen to the different (background) sounds and try to recognise them. When you are tired from listening, remove your instrument and pause for a while. Talk or read aloud for a while. In that way you will familiarise yourself with the sound of your own voice. Gradually, you will learn to use the instrument for longer and become more comfortable with it.

2. Listen outside; quiet & traffic

Go outside to a quiet place, e.g., the park or woods. Listen to the environmental sounds. Do you recognise them? Please be careful with sounds from heavy traffic at this stage of getting used to your instrument. Sometimes it sounds very loud. Try not to get frightened.

3. Have a conversation with a single person

Use your instrument in conversation with one person, a family member or a friend. Move to a quiet spot. Explain that you are now wearing a hearing instrument. Ask the other person to talk normally. Look at your conversation partner. If your instrument is tuned to your requirements you will be able to communicate better than before.

4. Listen to radio or television

Listen to the radio or television. Start with the news, then turn to another program. Ask a 'normal hearing' person to set the volume of your radio or television to a comfortable level. If necessary, adjust the volume on your hearing instrument.

If you cannot understand the radio or television, ask your hearing care practitioner to adjust your hearing instrument.

5. Get used to conversations in a group

Following conversations in a group is often difficult because of the background noise. Listen to the different voices. Try to recognise them by timbre or rhythm and link each voice to a person. Focus your attention on the person you want to understand. Practice this regularly.

If you did not understand something that was said, please ask for it to be repeated.

Ensure that you can see the face of your conversation partner(s) clearly and that there is sufficient light. This will help you to lipread. Avoid 'looking into the light'. Position yourself with your back towards the window, so that you can see the other person(s) better. Ask others to talk slowly and clearly. Talking louder does not help.

6. Visit public buildings

Visit public buildings. Try to sit near the speaker; try to be seated in the front rows in a show. Avoid a seat behind a pillar or in an alcove, you will be in a 'sound shadow.'

In a restaurant, sit with your back towards the wall. This avoids disturbing noises coming from behind you.

7. Use your telephone

Often, you can hear the telephone clearly with your hearing instrument in a microphone program. Hold the telephone handset 1-inch (2-3cm) from your ear and tilt the receiver outwards a little.

Your hearing instrument meets strict international regulations. Therefore, it should be possible to use a GSM telephone in most cases. However, in some circumstances, disturbance might be audible through your hearing instrument.

8. Use your instrument all day

Using your hearing instrument and practising with it is the best way to learn to hear again. Even if you can hear without an instrument in some cases. Try to wear your instrument all day. In that way, you will benefit the most.

Of course, a hearing instrument cannot restore natural hearing, but it will help you make the most of your hearing as it is today.

Go beyond these eight steps and discover the world of sound around you. Do the things you enjoy and listen to the sounds from your environment.

TROUBLESHOOTING GUIDE

SYMPTOM	CAUSE
Device is dead	Not turned on
	Dead battery
	Battery improperly inserted
	Broken receiver or receiver tube
	Blocked wax guard filter
Not loud enough	Receiver dome not inserted properly
	Blocked wax guard filter
	Change in hearing
	Excessive ear wax
	Hearing instrument settings not optimum
Whistles	Receiver tube and receiver dome not inserted properly in the ear
	Hearing instrument settings not optimum
Not clear, distorted	Weak battery
	Poorly fitting receiver tube
	Hearing instrument damaged
	Hearing instrument settings not optimum

POSSIBLE REMEDY

Turn on

Replace battery

Insert battery properly

Consult your hearing care professional

Consult your hearing professional or if you have been instructed change receiver dome or/and HF3 wax guard filter

Reinsert carefully

Consult your hearing professional or if you have been instructed change receiver dome or/and HF3 wax guard filter

Consult your hearing care professional

Consult your physician

Consult your hearing care professional

Reinsert carefully

Consult your hearing care professional

Replace battery

Consult your hearing care professional

Consult your hearing care professional

Consult your hearing care professional

Technical specifications

Audio signal technology

Digital

Hearing instrument maximum output (IEC 118-0 OES)

Model	Output
TRU62D	125 dB SPL
TRU62D Open	124 dB SPL
TRU 62D HPG	128 dB SPL
TRU62D HPG Open	128 dB SPL
TRU63DW	125 dB SPL
TRU63DW Open	124 dB SPL
TRU63DW HPG	128 dB SPL
TRU63DW HPG Open	128 dB SPL

Temperature test, transport and storage information

Beltone Hearing Instruments are subjected to various tests in temperature and damp heating cycling between -25 C and +70C according to internal and industry standards.

During transport or storage, the temperature should not exceed the limit values of -20C (68F) to 60C (140F) and relative humidity of 90% RH, non condensing (for limited time). The air pressure between 500 and 1100 hPa (mbar) is appropriate.

International warranty, service and repairs

Any digital hearing instrument from Beltone has an international warranty in the event of defects in workmanship or material, as described in applicable warranty documentation.

In its service policy, Beltone pledges to secure functionality at least equivalent to the original hearing instrument.

As a signatory to the United Nations Global Compact initiative, Beltone is committed to doing this in line with environment-friendly best practices. Hearing instruments therefore, at Beltone's discretion, may be replaced by new products or products manufactured from new or serviceable used parts, or repaired using new or refurbished replacement parts.

The warranty period of hearing instruments is designated on your warranty card, which is provided by your hearing care professional.

If your Beltone hearing instrument malfunctions, it must be repaired by a qualified technician. Do not attempt to open the case of the hearing instrument since this would invalidate the warranty. If your Beltone hearing instrument requires service, please contact your hearing care professional for assistance.

Your selected model

Your hearing care professional place a check mark in the below table to identify the model you have received.

Model Received	Type	Battery size	Receiver tube length
<input type="checkbox"/> TRU62D	RIE	10A	_____
<input type="checkbox"/> TRU62D Open	RIE	10A	_____
<input type="checkbox"/> TRU 62D HPG	RIE	10A	_____
<input type="checkbox"/> TRU62D HPG Open	RIE	10A	_____
<input type="checkbox"/> TRU63DW	RIE	312	_____
<input type="checkbox"/> TRU63DW Open	RIE	312	_____
<input type="checkbox"/> TRU63DW HPG	RIE	312	_____
<input type="checkbox"/> TRU63DW HPG Open	RIE	312	_____

Dome size: _____

Serial number Right: _____

Serial number Left: _____

Hearing care professional: _____

Be aware of information marked with the warning symbol



WARNING points out a situation that could lead to serious injuries, **CAUTION** indicates a situation that could lead to minor and moderate injuries



Equipment includes RF transmitter



Product is a Type B applied part



Please ask your local hearing care professional concerning disposal of your hearing instrument

CE
0297



Any issues relating to the EU Medical Device Directive 93/42/EEC, or Council Directive 1999/5/EEC on Radio Equipment and Telecommunications terminal equipment should be directed to Beltone A/S, Denmark

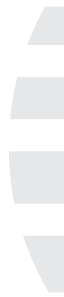

17446800-GB-10.04 Rev. A
Printed in Denmark
© Beltone 2010

Beltone A/S
Lautrupbjerg 7
DK-2750 Ballerup
Denmark
Tel.: +45 45 75 11 11
Fax: +45 45 75 11 19
www.beltone-hearing.com